

# Handlowa street I, Bolechowo, Poland

Production and services development areas

19 726 m<sup>2</sup> (1,9 ha)



Based on aerial photographs provided by [geoportal.gov.pl](http://geoportal.gov.pl)



Poznań- Ławica  
International  
Airport



Poznań -  
Wągrowiec  
railway



A2 highway - 27 km  
provincial road  
no. 196: 230 m



## Investment area

Section: Bolechowo,  
plot no. 371/38  
area: 19 726 m<sup>2</sup> (1,9 ha)

## Location

The plot is located in the northern part of the commune of Czerwonak, next to the border with the town of Murowana Goślina and near provincial road no. 196

## Land development

undeveloped area, currently used for agriculture purposes

## Access

From the provincial road via the municipal road (Handlowa street)

## Vicinity

The plot is located near the town of Murowana Goślina, 0.5 km from production plants located in Bolechowo (Solaris Bus & Coach, Amphenol El-Cab, Pressta, and others) and approximately 16 km from Poznań

## The purpose and method of land-use

The property is located in an area covered by the local zoning plan marked „1P/U” - these are areas designated for production facilities, warehouse, storage facilities or service buildings

## Form and procedure of sale

Sale by open oral tender



These materials are for informational purposes only and do not constitute an offer within the meaning of civil law.

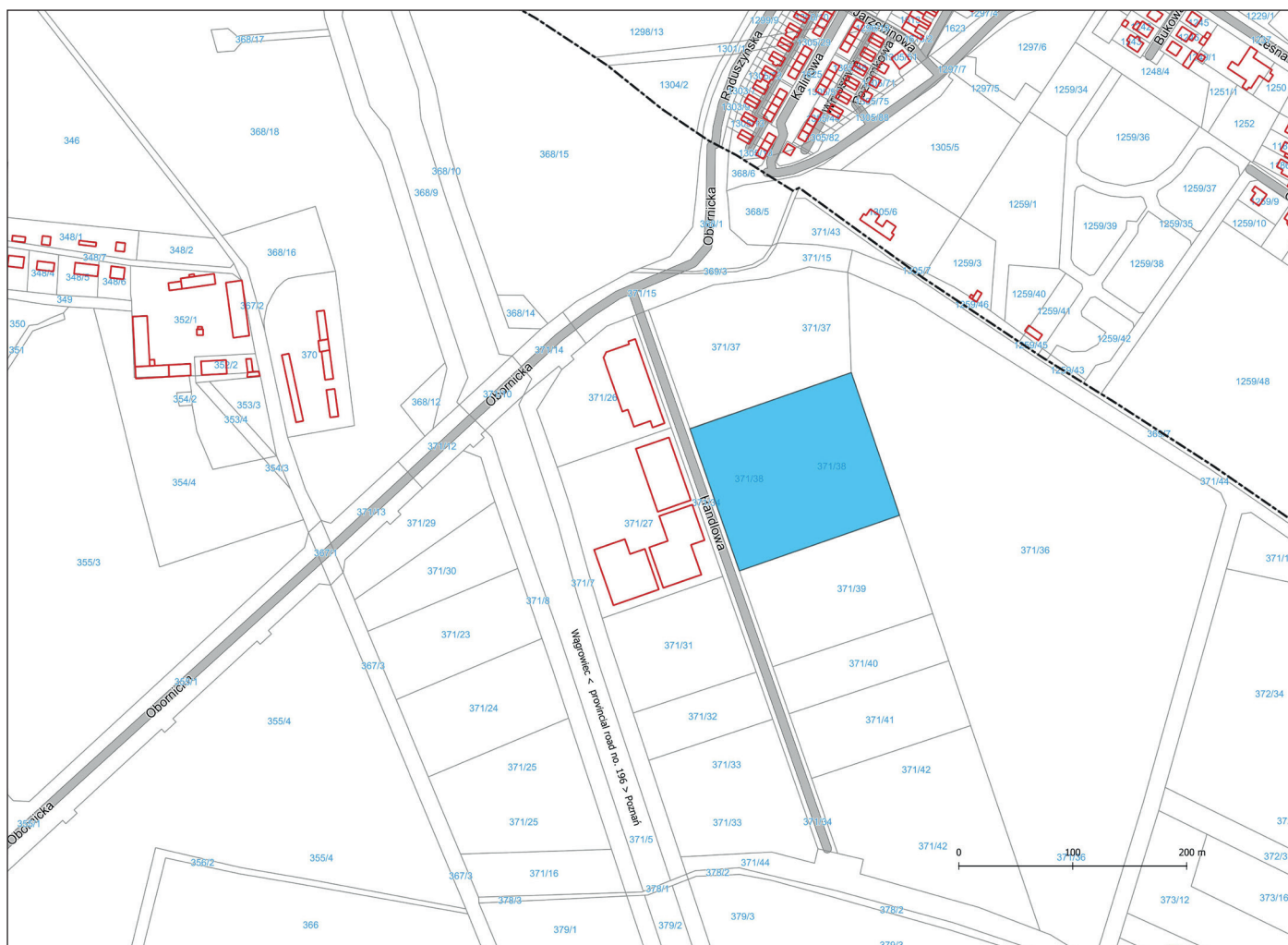

PODGiK, January 2026

Investment Project  
Management  
tel: +48 61 65 44 252,  
tel: +48 519 343 852

Czerwonak Commune Office,  
Źródłana Street 39,  
62-004 Czerwonak



www.czerwonak.pl

POZnań\*  
Metropolitan Area

# Handlowa street II, Bolechowo, Poland

Production and services development areas

17 352 m<sup>2</sup> (1,7 ha)



Based on aerial photographs provided by [geoportal.gov.pl](http://geoportal.gov.pl)



Poznań-Ławica  
International  
Airport



Poznań –  
Wągrowiec  
railway



A2 highway - 27 km  
provincial road  
no. 196: 500 m



## Investment area

Section: Bolechowo,  
plots no. 371/32, 371/33  
Total area: 17 352 m<sup>2</sup> (1,7 ha)

## Location

The plots are located in the northern part of the commune of Czerwonak, next to the border with the town of Murowana Goślina and near provincial road no. 196

## Land development

undeveloped area, currently used for agriculture purposes

## Access

From the provincial road via the municipal road (Handlowa street)

## Vicinity

The plot is located near the town of Murowana Goślina, 0.5 km from production plants located in Bolechowo (Solaris Bus & Coach, Amphenol El-Cab, Pressta, and others) and approximately 16 km from Poznań

## The purpose and method of land-use

The property is located in an area covered by the local zoning plan marked „1P/U” - these are areas designated for production facilities, warehouse, storage facilities or service buildings

## Form and procedure of sale

Sale by open oral tender



These materials are for informational purposes only and do not constitute an offer within the meaning of civil law.

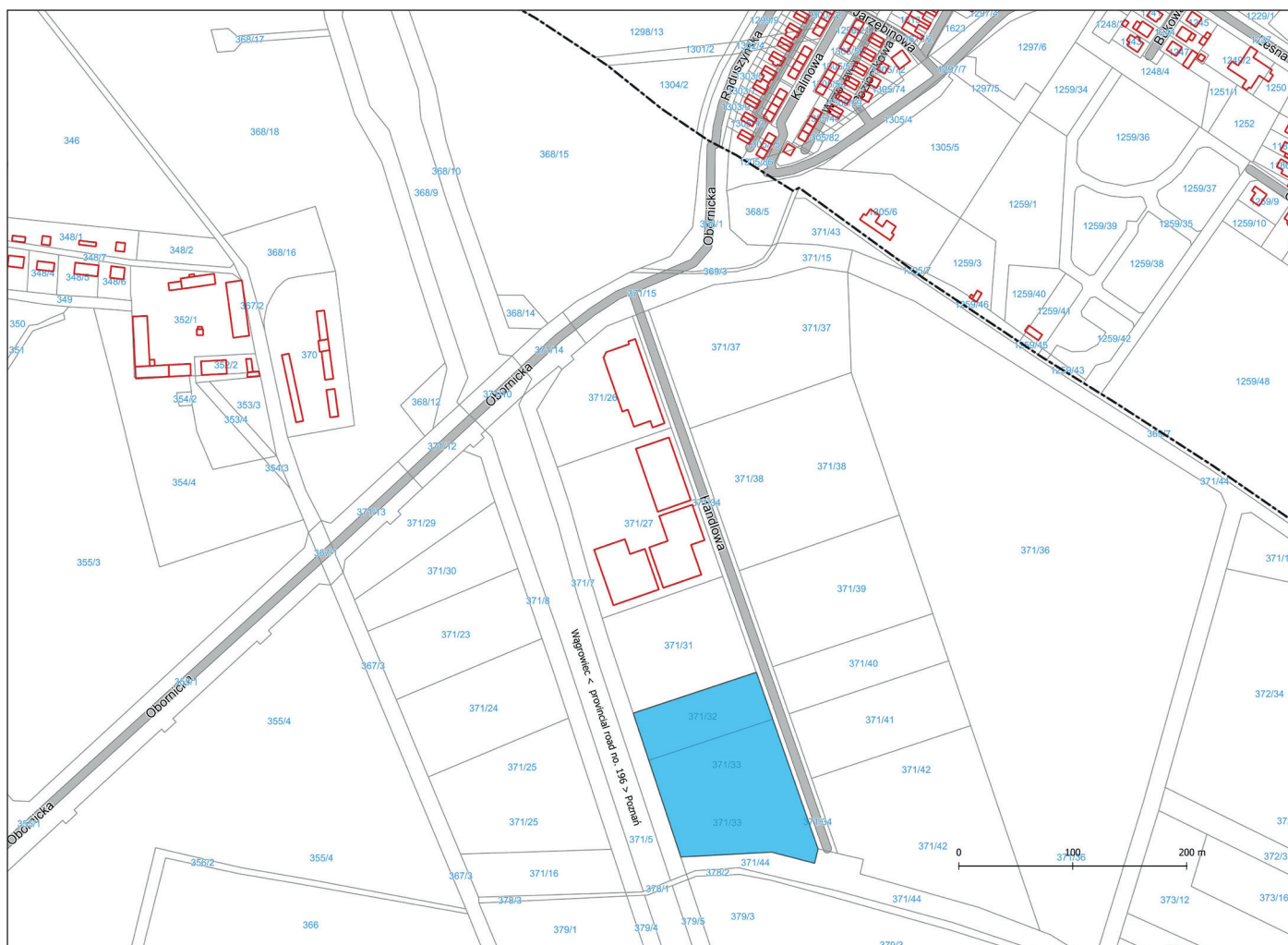

Investment Project  
Management  
tel: +48 61 65 44 252,  
tel: +48 519 343 852

Czerwonak Commune Office,  
Źródłana Street 39,  
62-004 Czerwonak



www.czerwonak.pl

POZnań\*  
Metropolitan Area

# Żołnierzy Niezłomnych street, Koziegłowy, Poland

Services development area

5 876 m<sup>2</sup> (0,5 ha)



Based on aerial photographs provided by [geoportal.gov.pl](http://geoportal.gov.pl)



Poznań- Ławica  
International  
Airport



Poznań –  
Wągrowiec  
railway



A2 highway - 14 km  
provincial road  
no. 196



## Investment area

Section: Koziegłowy,  
plot no. 154/4  
Area: 5 876 m<sup>2</sup> (0,5 ha)

## Location

The plot is located in central part of the Commune of Czerwonak in the centre of Koziegłowy. Close to a commercial area, a school and a centre of sport and recreation.

## Land development

unused area

## Access

From the municipal road - Żołnierzy Niezłomnych street that is connected with provincial road No. 196

## Vicinity

The property is surrounded by commercial and residential buildings, a school and a sports and recreation centre. The city of Poznań is located 9 km from the property

## The purpose and method of land-use

The property is located in an area covered by the local zoning plan marked „3U” - these are areas designated for service development areas



## Form and procedure of sale

Sale by open oral tender

These materials are for informational purposes only and do not constitute an offer within the meaning of civil law.



PODGiK, January 2026

Investment Project  
Management  
tel: +48 61 65 44 252,  
tel: +48 519 343 852

Czerwonak Commune Office,  
Źródłana Street 39,  
62-004 Czerwonak



www.czerwonak.pl

POZnań\*  
Metropolitan Area

# Obornicka street, Bolechowo, Poland

Production and services development areas

15 756 m<sup>2</sup> (1,5 ha)



Based on aerial photographs provided by [geoportal.gov.pl](http://geoportal.gov.pl)



Poznań-Ławica  
International  
Airport



Poznań -  
Wągrowiec  
railway



A2 highway - 27 km  
provincial road  
no. 196



## Investment area

Section: Bolechowo,  
plots no. 371/23, 371/30  
Total area: 15 756 m<sup>2</sup> (1,5 ha)

## Location

The plots are located in the northern part of the commune of Czerwonak, next to the border with the town of Murowana Goślina and near provincial road no. 196

## Land development

undeveloped area, currently used for agriculture purposes, overhead line of high voltage over the small part of the plot no. 371/23

## Access

From the provincial road via the internal service road

These materials are for informational purposes only and do not constitute an offer within the meaning of civil law.

## Vicinity

The plots are located in the northern part of the commune of Czerwonak, near to the border with the town of Murowana Goślina and near provincial road no. 196

## The purpose and method of land-use

The property is located in an area covered by the local zoning plan marked „1P/U” - these are areas designated for production facilities, warehouse, storage facilities or service buildings

## Form and procedure of sale

Sale by open oral tender

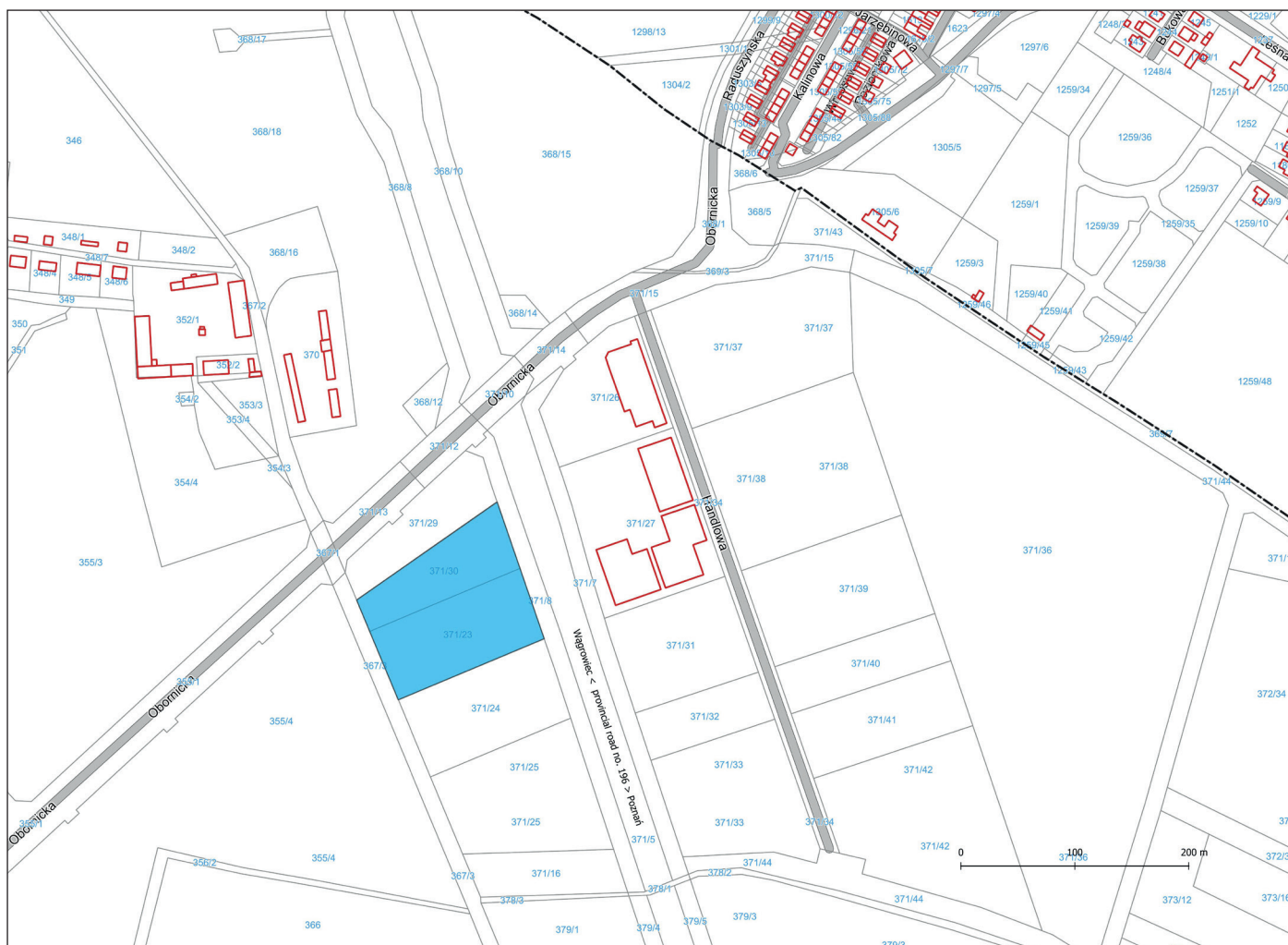

Investment Project  
Management  
tel: +48 61 65 44 252,  
tel: +48 519 343 852

Czerwonak Commune Office,  
Źródłana Street 39,  
62-004 Czerwonak



www.czerwonak.pl

POZnań\*  
Metropolitan Area

# Poznańska street I, Bolechowo, Poland

Production, services and trade development areas

67 135 m<sup>2</sup> (6,7 ha)



Based on aerial photographs provided by geoportal.gov.pl



Poznań-Ławica  
International  
Airport



Poznań –  
Wągrowiec  
railway



A2 highway – 27 km  
district road  
no. 2029 – 100 m



## Investment area

Section: Bolechowo,  
plots no. 372/34, 371/19  
total area: 67 135 m<sup>2</sup> (6,7 ha)

## Location

The plots are located in the northern part of the commune of Czerwonak, next to the border with the town of Murowana Goślina and near provincial road no. 196

## Land development

currently used as a landing site for paragliders

## Access

From the District road via the planned internal road

## Vicinity

The plots are located near the town of Murowana Goślina, 0.5 km from production plants located in Bolechowo (Solaris Bus & Coach, Amphenol El-Cab, Pressta, and others) and approximately 16 km from Poznań

## The purpose and method of land-use

The property is located in an area covered by the local zoning plan marked „2P/U” - these are areas designated for production facilities, warehouse, storage facilities or service buildings

## Form and procedure of sale

Sale by open oral tender



These materials are for informational purposes only and do not constitute an offer within the meaning of civil law.

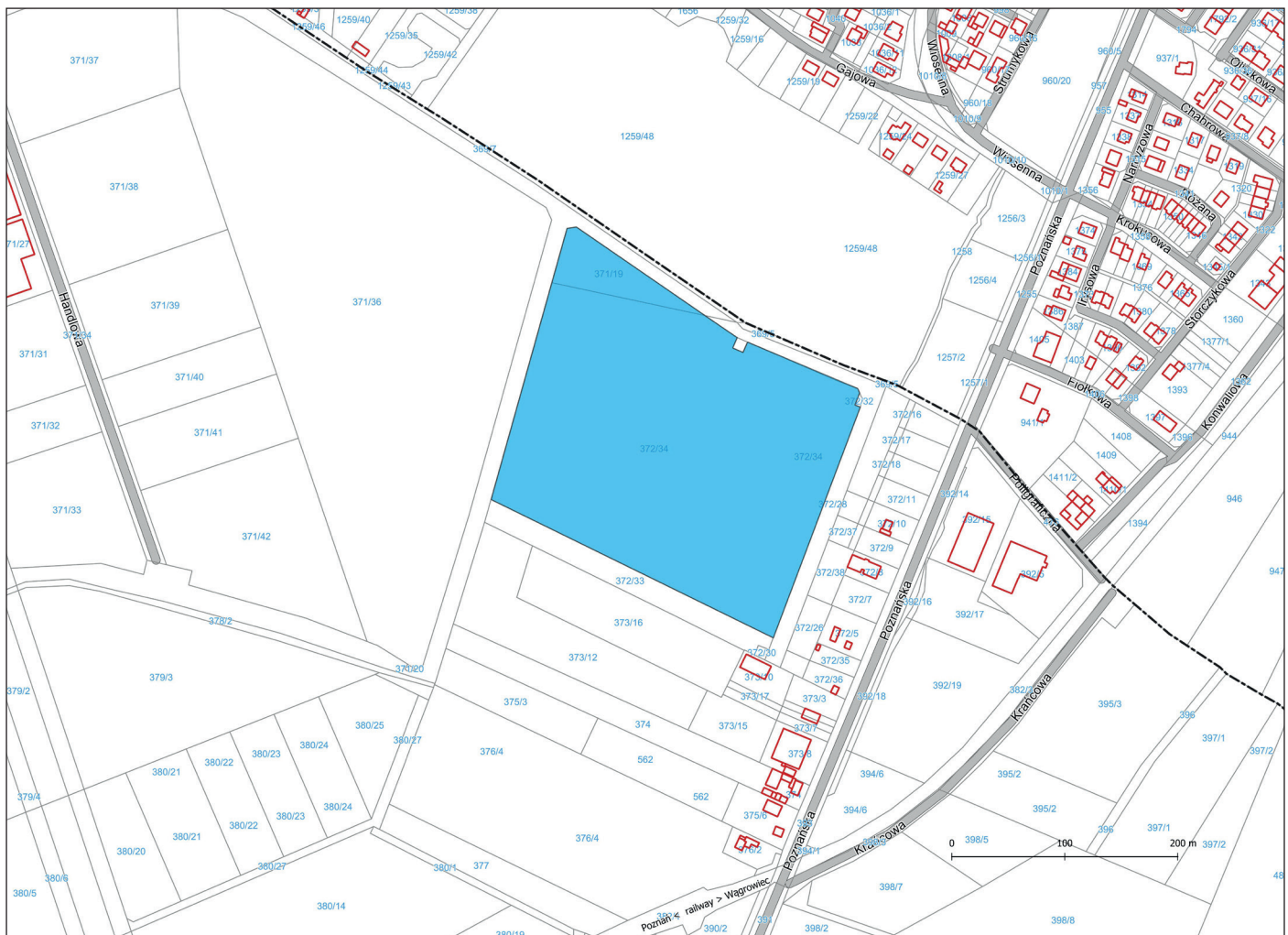

PODGiK, January 2026

**Investment Project Management**  
tel: +48 61 65 44 252,  
tel: +48 519 343 852

**Czerwonak Commune Office,**  
Źródłana Street 39,  
62-004 Czerwonak



[www.czerwonak.pl](http://www.czerwonak.pl)

**POZnań\***  
Metropolitan Area

# Poznańska street II, Bolechowo, Poland

Production and services development areas

99 592 m<sup>2</sup> (9,9 ha)



Based on aerial photographs provided by [geoportal.gov.pl](http://geoportal.gov.pl)



Poznań-Ławica  
International  
Airport



Poznań –  
Wągrowiec  
railway



A2 highway – 27 km  
provincial road  
no. 196 – 120 m



## Investment area

Section: Bolechowo,  
plot no. 371/36  
Area: 99 592 m<sup>2</sup> (9,9 ha)

## Location

The plot is located in the northern part of the commune of Czerwonak, next to the border with the town of Murowana Goślina and near provincial road no. 196

## Land development

undeveloped area, currently used for agriculture purposes, overhead line of medium-voltage

## Access

From the provincial road via the internal municipal road

## Vicinity

The plot is located near the town of Murowana Goślina, 0.5 km from production plants located in Bolechowo (Solaris Bus & Coach, Amphenol El-Cab, Pressta, and others) and approximately 16 km from Poznań

## The purpose and method of land-use

The property is located in an area covered by the local zoning plan marked „1P/U” - these are areas designated for production facilities, warehouse, storage facilities or service buildings

## Form and procedure of sale

Sale by open oral tender



These materials are for informational purposes only and do not constitute an offer within the meaning of civil law.

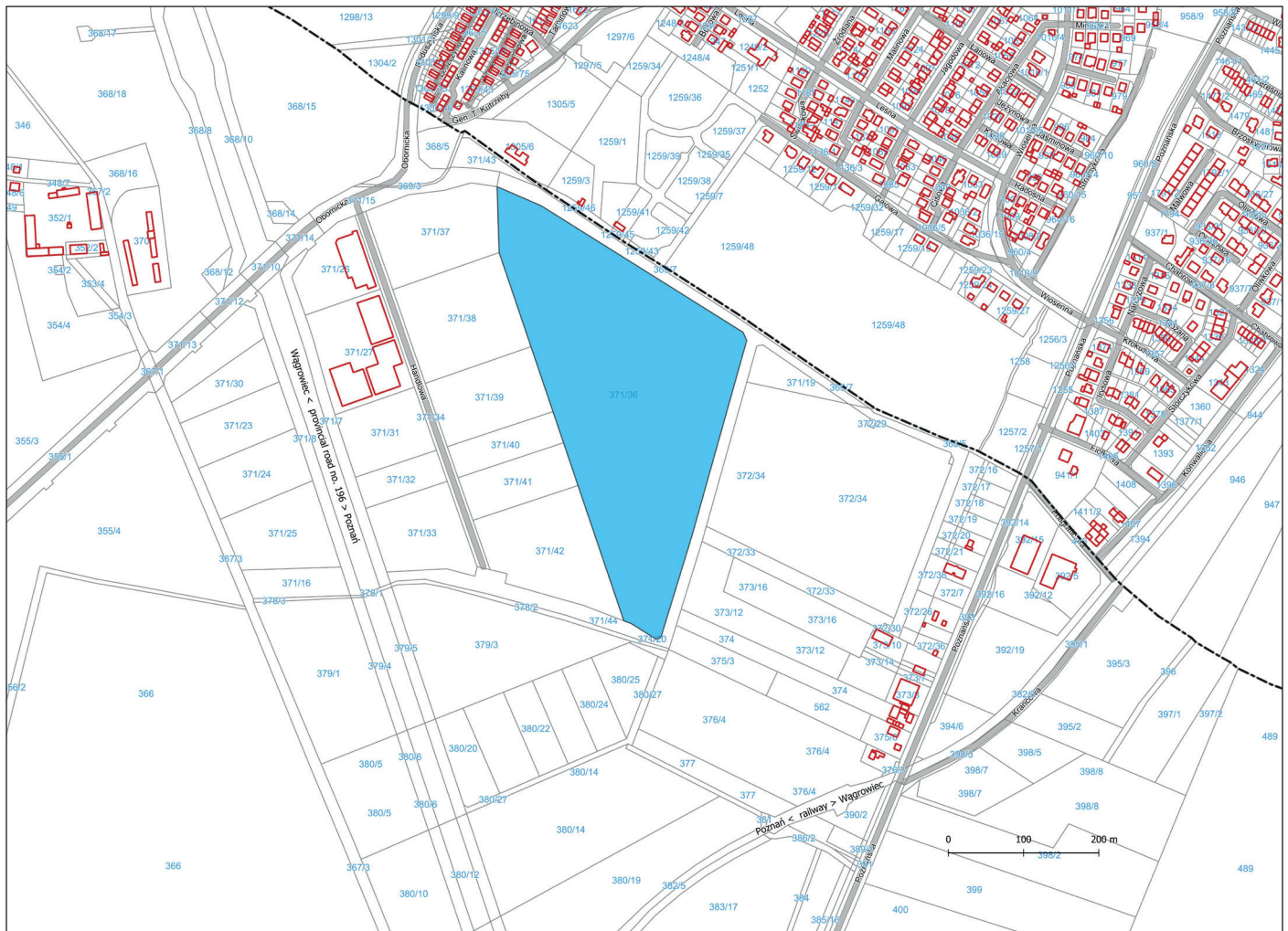

PODGiK, January 2026

Investment Project  
Management  
tel: +48 61 65 44 252,  
tel: +48 519 343 852

Czerwonak Commune Office,  
Źródłana Street 39,  
62-004 Czerwonak



www.czerwonak.pl

POZnań\*  
Metropolitan Area